

Guthrie County, Iowa

FARMLAND AUCTION | LISTING #16025

Thursday, March 31st, 2022 at 10:00 AM

Jamaica Community Center | NW Corner of Main Street & Van Nest Street | Jamaica, Iowa 50128

High quality farmland in strong farming area! Peoples Company is representing the beneficiaries of the McDermott Revocable Trust in the sale of 183.65 total acres m/l of prime Guthrie County, Iowa farmland near Jamaica, Iowa.

The farmland will be sold as four individual tracts with top-producing soils types and CSR2 soil ratings around 90! Farms are leased for the 2022 farm year with Buyer receiving one-half of the cash rent at closing and one-half from Farm Tenant in fall of 2022.



TRACT 1 | 40 ACRES M/L



38.71 CROPLAND ACRES | CSR2 RATING 89.4



MATT ADAMS
515.423.9235

Matt@PeoplesCompany.com

JARED CHAMBERS
641.414.0234

Jared@PeoplesCompany.com

SCAN THE QR CODE TO
THE BELOW WITH YOUR
PHONE CAMERA TO VIEW
THIS LISTING ONLINE!



TRACT 2 | 78 ACRES M/L

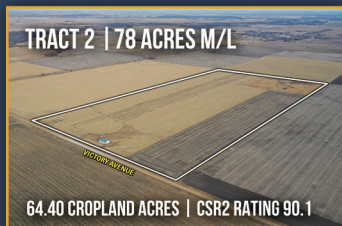

64.40 CROPLAND ACRES | CSR2 RATING 90.1

11.20 Acres in CRP with Annual Payment \$4,542

TRACT 3 | 40 ACRES M/L



38 CROPLAND ACRES | CSR2 RATING 89.3

TRACT 4 | 25.65 ACRES M/L

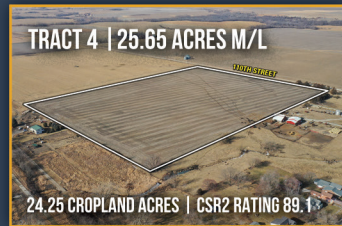

24.25 CROPLAND ACRES | CSR2 RATING 89.1